



Gripper Chain™

For form, fill, and vacuum seal
wrapping applications

The complete package — only from U.S. Tsubaki

- Reliable performance
- Extended wear life
- Competitive price
- Quick delivery



Tsubaki: The choice for chain™

Tsubaki Gripper Chain™



A formidable new force has taken hold of wrapping operations: Gripper Chain™ from Tsubaki.

Our high-performance roller chain is now available with both conventional and innovative new side-swivel gripper attachments for form, fill, and vacuum seal applications.

Enhanced operation

Tsubaki gripper attachments feature reliable clamping mechanisms to ensure precise positioning. High-performance springs are designed to last more than 10 million cycles, even at high speeds. Our Type K attachment's side-swivel design allows optimal material feed through to ensure your lines run smoother.

Exclusive! Quickly cut to length

Tsubaki is the only manufacturer to offer Gripper Chain™ with recessed riveted pins for easy chain length adjustment. Keep production rolling with less downtime.



Attachment design

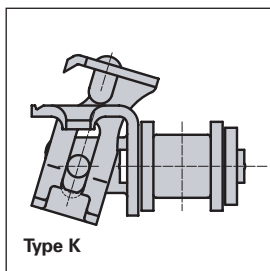

The clamping mechanism on Tsubaki's Type K gripper attachments opens vertically, then sideways for easy film engagement.

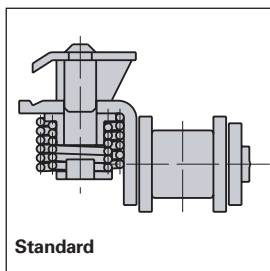

High-quality Standard attachments which open straight up and down, are also available.

Get a grip on truly profitable performance

Discover the difference Tsubaki's high-quality base chain makes in your bottom line.

- Lower maintenance costs
- Increased uptime
- Increased productivity

Quick, uniform start-up

Factory pre-loading minimizes initial chain elongation. Colored connecting links are easy to identify while in service and convenient to install with retaining clips.



Extended service life

FDA-approved food-grade (H3) lubricant is applied at the factory following assembly to ensure uniform coverage and protection of each chain component.

Extensive selection

Nickel-plated base chains are available from stock. Alternate materials for special applications — including corrosion resistant stainless steel and now, maintenance-free LAMBDA® — can be quickly made-to-order.

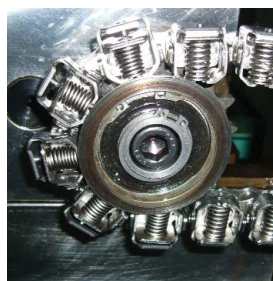

Precision machined sprockets for both Type K and Standard Gripper Chain™ applications are available on a made-to-order basis.

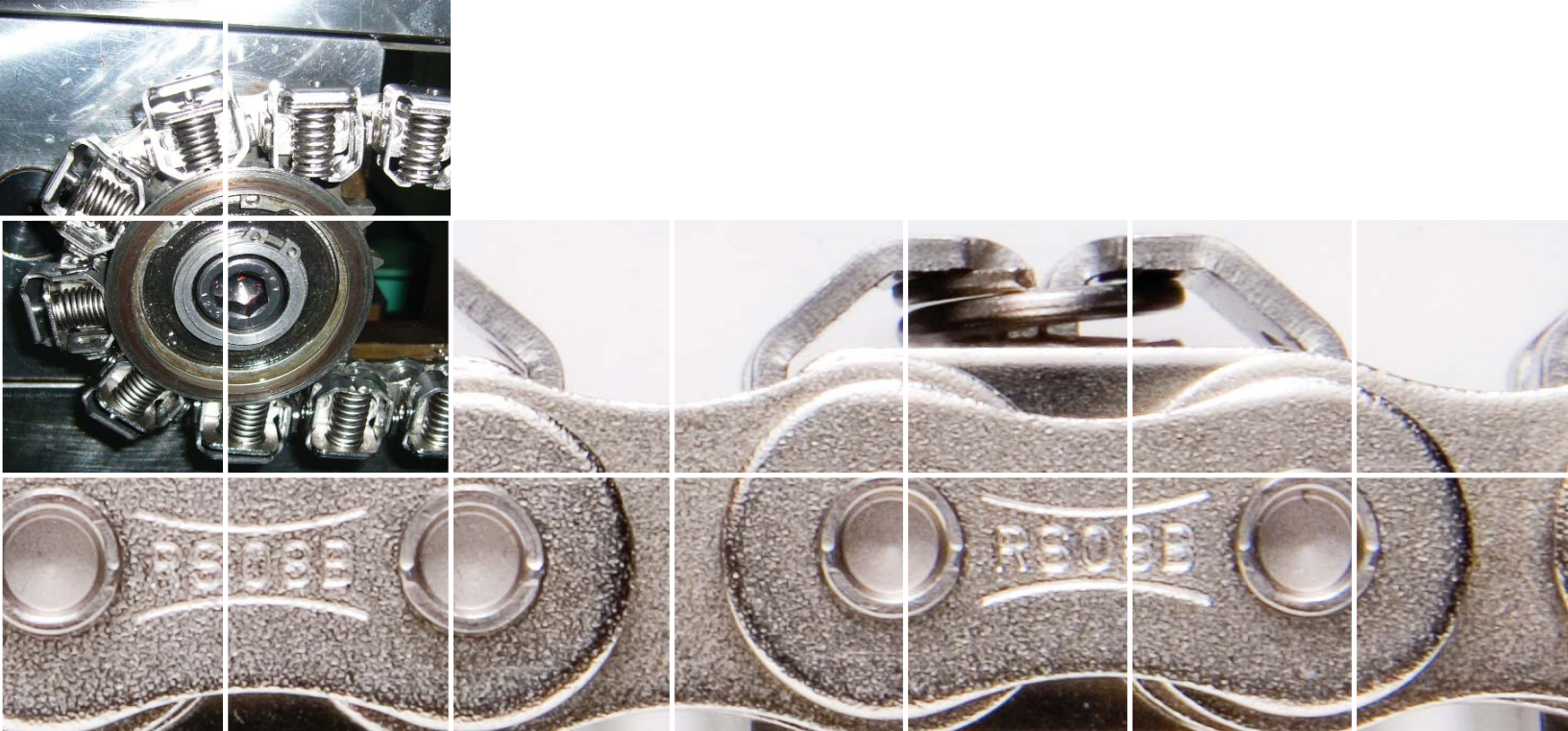

RS08BNPKUTM Gripper Chain™

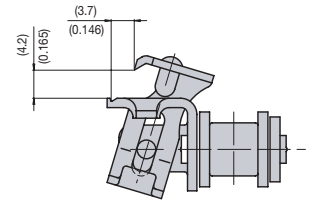
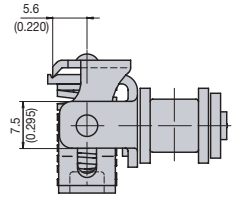
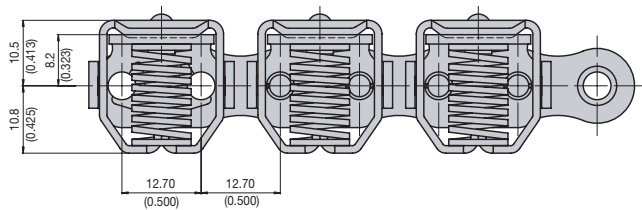

RS10BNPKUTM Gripper Chain™

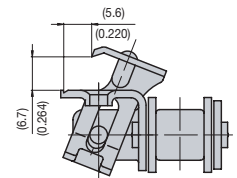
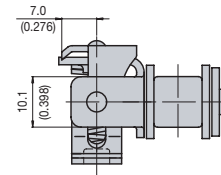
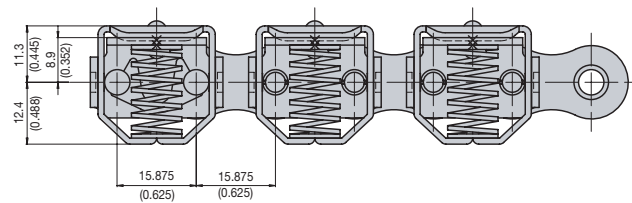

RS08BNPKUTS Gripper Chain™

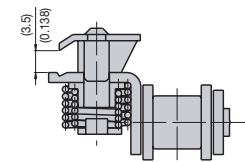
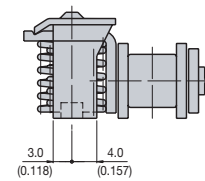
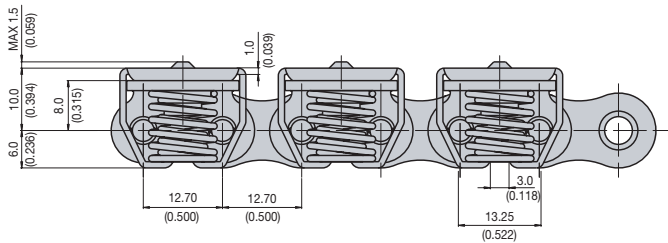

ISO Ref.	Chain No.	Connecting Link	Pitch		Roller Dia.		Inside Width		Clamp Type	Clamping Force	Materials		
			mm	in.	mm	in.	mm	in.			N	Base Chain	Clamp
08B-1	RS08BNPKUTM	RS08BNPKUTMCL	12.7	.500	8.51	.335	7.75	.305	Type K	50	NP	304SS	SA
10B-1	RS10BNPKUTM	RS10BNPKUTMCL	15.9	.625	10.16	.400	9.65	.380	Type K	70	NP	304SS	SA
08B-1	RS08BNPKUTS	RS08BNPKUTSCL	12.7	.500	8.51	.335	7.75	.305	Standard	55	NP	304SS	SA

NP = Nickel-Plated Steel SS = Stainless Steel SA = Special Alloy
 Notes: Do not twist chain. Use care not to damage attachment when unwinding chain from reel.

Gripper Chain™

For form, fill, and vacuum seal wrapping applications



Tsubaki: The choice for chain™

- ASME/ANSI Chain
- Attachment Chain
- Corrosion Resistant Chain
- Maintenance-free Chain
- Plastic Chain
- Custom/Specialty Chain
- Sprockets
- Power Transmission Components



Corporate Headquarters

301 E. Marquardt Drive
Wheeling, IL 60090
Tel: (800) 323-7790
Tel: (847) 459-9500
Fax: (847) 459-9515
www.ustsubaki.com